



# Shift Control Solenoid Valve A/B

## Test

1. Measure the resistance between the A terminal (BLU; solenoid valve A) of the shift control solenoid valve/linear solenoid harness connector and body ground and between the B terminal (GRN; solenoid valve B) and body ground.

**STANDARD: 12–24Ω**

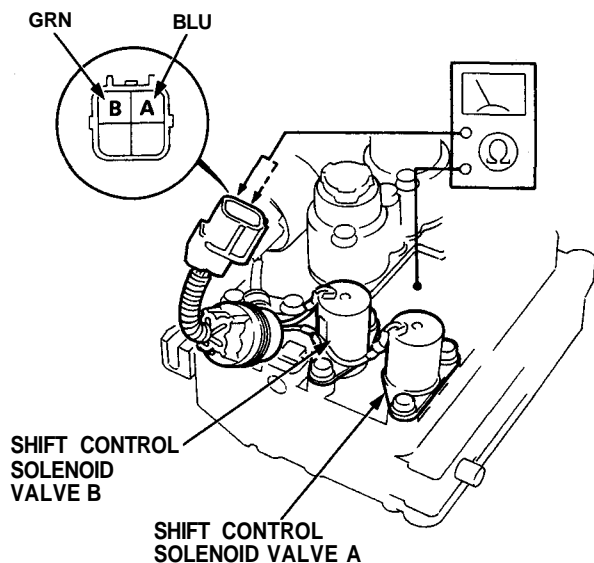

2. Replace the shift control solenoid valve assembly if the resistance is out of specification.
3. If the resistance is within the standard, connect the A terminal of the shift control solenoid valve/linear solenoid harness connector to the battery positive terminal and the negative terminal to body ground. A clicking sound should be heard. Connect the B terminal to the battery positive terminal. A clicking sound should be heard.
4. If a clicking sound is not heard, replace the shift control solenoid valve assembly.

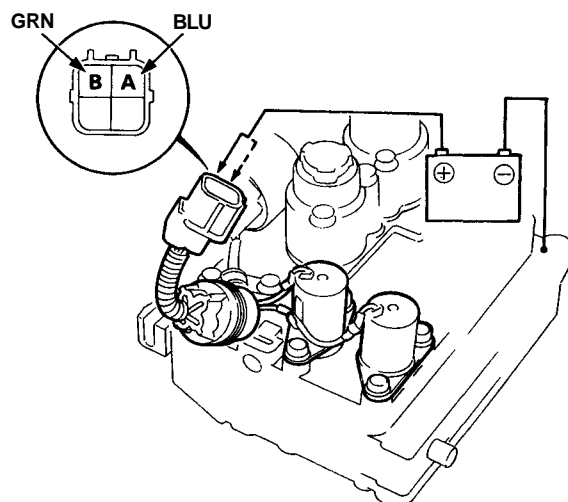

## Replacement

**NOTE:** Shift control solenoid valve A and B must be replaced as an assembly.

1. Remove the shift control solenoid valve A, B and linear solenoid/throttle valve body from the lower valve body assembly.
2. Disconnect the linear solenoid terminals.

### THROTTLE VALVE BODY/LINEAR SOLENOID

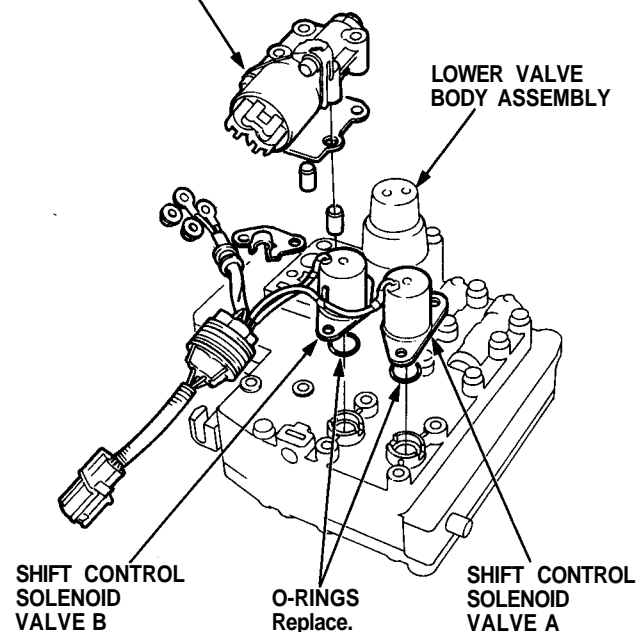

3. Clean the mounting surfaces and oil passages.
4. Connect the linear solenoid terminal then install the shift control solenoid valve A, B and linear solenoid/throttle valve body on the lower valve body.

